

# Sprays of Rays Owner's Manual

LVLP (Low Volume Low Pressure)  
Spray Tanning Systems for the Tanning Professional



*Sprays of Rays II*

Weight 6 ½ lbs.  
Dimensions 8" w x 8" d x 6 ¾" h  
Shipping weight 16 lbs.  
120 or 240V Turbine

## Table of Contents

	<u>Page</u>
Components in your shipment	3
Set-up	3-4
Choosing your spraying pattern	4
What does the control ring do?	5
Controlling the amount of solution	5
Variable speed control	6
Preparing for the tanning session	6
Let the tanning session begin	7
Maintenance	8
Gun – cut-away picture	9
Troubleshooting	10
Noise level ratings in dB	11
Warranty	12
Warnings and Cautions	12
Contact Information	13

### Components in your shipment:

Turbine housing  
10' Flex Air Hose  
Cleaning kit

HVLP spray gun with 6-oz. cup  
2 extra 6-oz. cups with lids  
Gun (cup) holder

### Setting up:



Screw the flexible air hose on the threaded outlet on the turbine housing.



Attach the gun onto the other end of the air hose by pulling back on the quick disconnect (QD). Insert the gun and release the QD. It will click when locked in place.

To install the cup holder, simply screw the bracket into the holes with the screws provided.

As you are looking at the end of the gun, this is the air cap which you simply turn to the pattern you prefer. Experiment with all of the patterns to find what you like best. The gun has been adjusted and is ready to spray. To make adjustments to suit your style, here's all you do.



This is the setting to spray a round pattern. The air cap is at a slant.



This is the setting for a horizontal pattern. The air cap ears are vertical.  
Hint: Spray horizontal-ears vertical  
Spray vertical-ears horizontal

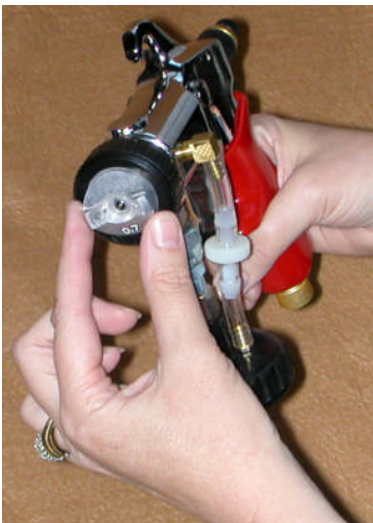

This is the setting for a vertical pattern. The air cap ears are horizontal.

As you are looking at the end of the gun, feel the needle in the center of the air cap. You should barely feel it coming through the air cap. Turn the black pattern control ring and watch and feel with your finger how the needle inside recedes and extends as you turn the ring in different directions. Now return it to the initial setting – again, you will barely feel the needle coming through the air cap.

### What does the pattern control ring do?

By moving the air cap in or out, you are controlling the amount of air coming through the air cap. If you turn the dial so that the needle is completely recessed behind the air cap, more air than necessary would flow along with the solution being sprayed. If you turn the ring so that the needle is coming out through the air cap as much as it can, you are reducing the flow of air so you would have more solution flow and not enough air to atomize it. Atomizing is the combination of air and solution to make a fine mist.

### Controlling the amount of solution.

The black knob and brass ring at the back of the gun control the amount of solution flowing through the gun. If you turn the knob out and tighten down the brass ring, you will see that the trigger does not need to be pulled back very far for the solution to be delivered. You should have approximately 5/16 inch of visible threading showing on the adjustment screw on the outside of the locking ring. That is measured from the outside edge of the brass locking ring and the beginning of the largest part of the material control knob.

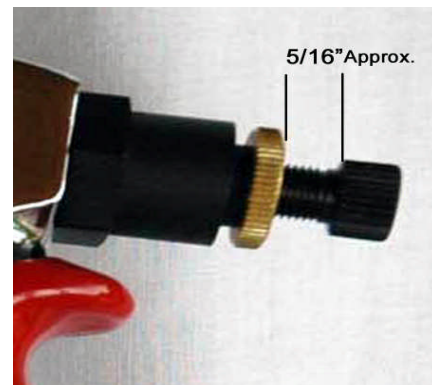

### To adjust the variable speed control:

We recommend that you start up the unit with the rheostat set on 10, then turn it down to the desired setting for spraying (between 5-6 is recommended).



### **Warning:**

Always turn the system off when not in use by switching the on/off rocker switch. **DO NOT** turn the rheostat down to an inaudible level. If turned down but left in the ON position can result in the motor burning out.

Recommended items to have on hand prior to your tanning session:

Towel to stand on	Access to water for clean-up
Barrier cream for knees/feet	Beauty rounds (cream make-up application sponges)
Hair cover	Plastic gloves
Good lighting	DHA or training spray

Each salon or home set-up will be different when it comes to ventilation, drying fans, etc. There is very little overspray with the system, but proper ventilation can be achieved with an overspray booth. Plans and pictures of overspray booths can be found at [www.abtan.com](http://www.abtan.com) (see our home page for a link to their site).

### Preparing For the Tanning Session

Before a tanning session, the client should shower and use an exfoliant. Women should shave their legs prior to exfoliating, as shaving creams that contain oils will block the pores and the DHA will not penetrate. This cleans the skin's surface and sloughs off dead skin cells. The client should not apply any lotions, fragrances, creams, makeup or deodorant prior to the tanning session as this can cause a streaked, uneven tan. They should wear an old bathing suit or undergarments taking into consideration the tan line they wish to achieve. Disposable bras, thongs and boxers are also available on the market that can be offered by the tanning salon/spa.

Long hair should be pulled up away from the neck and face. A hair cover is recommended although DHA will not affect hair color.

Nail polish or a clear coat should be applied to the fingernails and toenails to prevent nail discoloration. Barrier creams are also sold for this purpose.

If the client is a walk-in and has not exfoliated, there are spray-on exfoliants that can be applied with the spray system. It should be sprayed on one section of the body at a time, and toweled off with dry paper towels while the skin is wet.

The fabrics of the clothing they wear during and after the spray tanning could become stained, depending on the fabric. They should wash all garments upon returning home. DHA will not come out of 100% silk fabrics.



Unscrew the cup from the gun and fill 2/3 full with One Day Spray training solution or DHA. Screw it back onto the gun, keeping it level and making sure it is properly threaded. It's easiest to do this without the air hose attached. Hold the gun as seen in the picture, not by the handle. When you screw the cup onto the gun, hand tighten. Over-tightening can cause the seal inside the lid to break away from the lid.

### **You are all set up, so Let's Get Spraying**

It will be easiest if you put the machine on a tabletop so that you can easily see the rheostat and on/off switch.

Place a towel on the floor in the area you have designated for spraying. You should apply barrier cream or moisturizer to the knees, elbows, sides of feet and backs of heels. This allows for less penetration of the solution for a more natural-looking tan.

Slip on your plastic gloves and have your sponge handy. Have your volunteer turn his/her back to you. Turn the machine on with the rheostat set on 10 and then reduce to a level of 5-6 and begin spraying approximately 4 inches away from the skin.

Begin on the person's back, starting at the neck. Spray down one side of the back, down to the foot. Repeat the process on the other side of the back. Make sure the person bends forward to spray any creases they may have. Then have them turn to the side and spray the shoulder to the hand. Have them raise their arm up while you spray the inside of the arm down to the armpit and down the side of the body and leg to the foot.

Spray the front similar to the back, lifting or bending any parts of the body that are causing creases. Be sure to spray inner thighs as well. Lastly it's time to spray the neck and face. Have the person close their eyes, hold their breath, and close their lips tightly - apply the solution in an even manner.

Don't spray the palms of the hands or the bottoms of feet.

If a dark spray is being applied, check that all areas have been covered. If a clear spray is being applied, a second coat may be necessary to ensure coverage. It's recommended that you start with a dark solution so you can tell where you have sprayed.

It's handy to have a make-up application sponge for dabbing up any areas that have excess solution or applying small amounts of solution to the feet or areas with too little solution. If you make a mistake and spray too much solution, simply wipe it off and re-apply.

The person should avoid lowering their arms or pressing their thighs together until dry to avoid streaking or smudging off the solution. A fan or blower can be used to accelerate the drying process. You can also remove the cup over a basket or sink, letting any excess solution run out of the tube. Spray air into the basket to get all remaining solution out of the line. Then blow air on the person to help in the drying process.

## Daily Maintenance

### The Last Client has Gone Home for the Day – Time to Clean Up

It is recommended that any solutions in the cups be emptied back into their original containers. The cups should be washed out with lukewarm water and a drop of dish soap, rinsed, inverted and left to dry overnight. For cleaning of the gun, fill one of the cups with 2-3 ounces of lukewarm water and a drop of dish soap. Turn the rheostat to 10 and spray the soapy water through the gun into a sink. Then fill the cup with clear water and spray until the water runs clear. Remove the cup, spray air only for 30 seconds. Wipe the gun down, as well as the hose and machine.

### On-going maintenance

It is recommended that you use the gun cleaning kit once every two-four weeks to ensure your gun's peak performance. Check your air pre-filter every week. It can be cleaned with any mild soap and water, dried and reinstalled. Replace pre-filter as necessary. To order new pre-filters, give us a call at 800-328-4827 Ext. 5981.

### Cleaning the gun with the gun cleaning kit (included with your system):

Included in this kit: cleaning brush, nozzle removal tool, packing adjustment wrench.



We assume that you have done your daily maintenance by running the soapy water and clear water through the gun

1. Remove pattern control ring (black ring on the front of the gun) by unscrewing it counterclockwise, remove detent plate and detent spring and clean in soapy water, rinse.
2. Remove material control knob at the back of the gun. This is the large black knob that butts up to the silver part of the gun. Unscrew that counterclockwise. Pull back on the trigger and pull the needle out through the back of the gun.
3. Remove the nozzle with the nozzle removal tool. The tool will fit tightly around the nozzle. Turn it counterclockwise. If it is hard for you to turn, lay the gun on the side of a table flat side down, holding the tool over the nozzle and tap with a hammer to loosen the nozzle enough for you to unscrew by hand. Clean nozzle with soapy water, rinse.
4. It should not be necessary to clean the clear tubes running up from the cup if you have been running soapy water and clear water through the gun on a daily basis.
5. Attach the turbine air hose to the gun and blow air through to dry out the body
6. Apply a thin coat of Vaseline to the shaft of the needle, threads of the material control body and adjustment screw, and the threads of pattern control ring.
7. Reassemble gun.

# SPRAYS OF RAYS HVLP Gun (cut-away version)

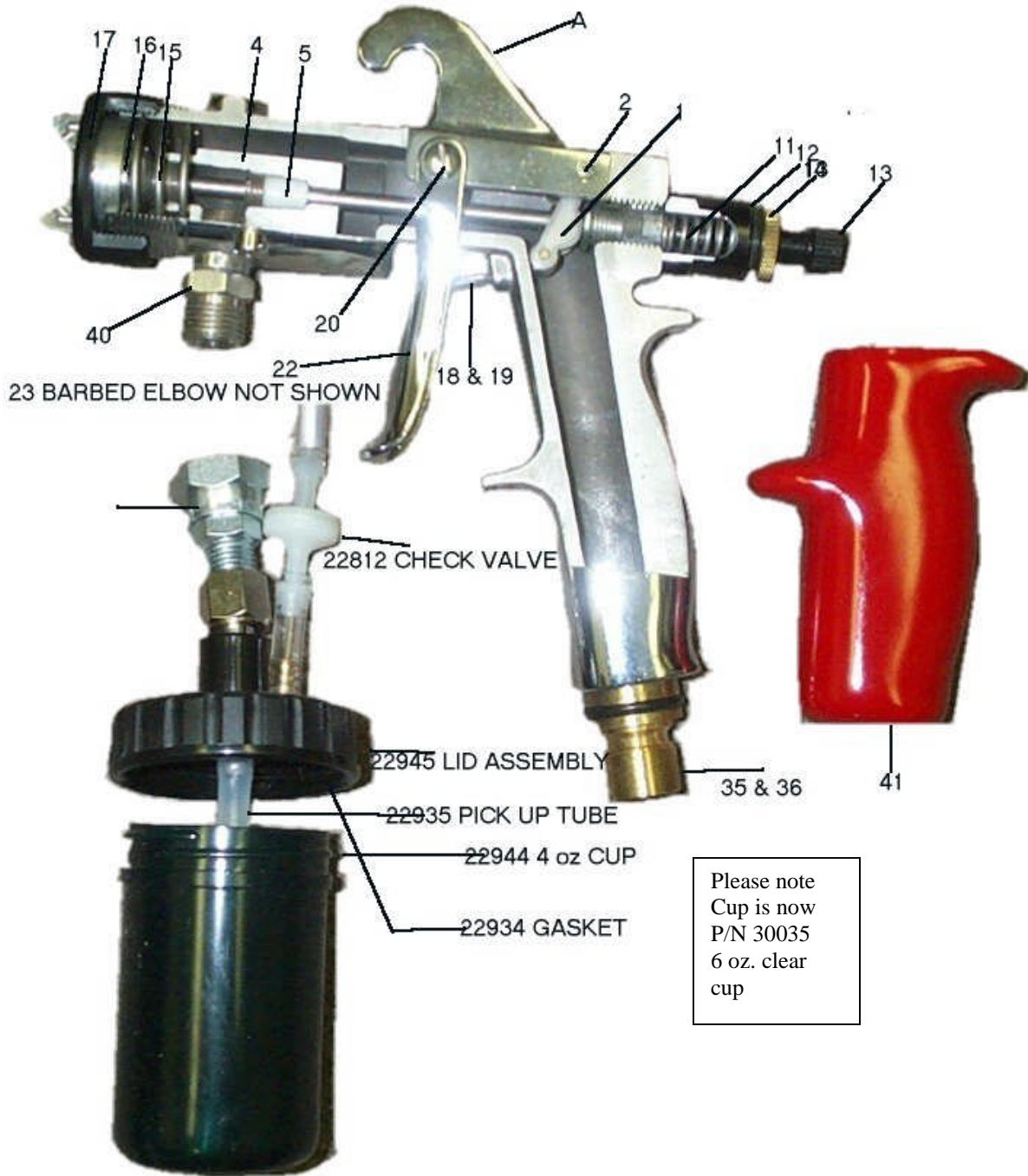

Please note  
Cup is now  
P/N 30035  
6 oz. clear  
cup

A	22000	Gun body	13	22013	Adjustment screw	20	22021	Trigger screw
1	22001	Actuator	14	22014	Locking ring	22	22020	Trigger
2	22002	Actuator pin	15	22015	Detent spring	23	22714	Barbed elbow
4	22004	Nozzle holder	16	22016	Detent plate	35	22712	Gun male QD
5	22005	Packing	17	22017	Pattern control ring	36	22721	“O” ring
11	22011	Needle return spring	18	22018	Trigger pin guide	40	22022	Fluid fitting
12	22012	Body material control	19	22019	Trigger pin	41	22715	Grip

## TROUBLE SHOOTING

Problem	Probable cause	Solution
Turbine not operating at all	A. No power to the turbine unit B. Rocker switch tripped	A. Check power source. B. Turn switch off and on to reset. If caused by excessive heat, allow unit to cool.
Low air flow	A. Filter is blocked. B. Unit discharge vents are obstructed. C. Kink in hose D. Broken or damaged hose.	A. Clean or replace pre-filter or main filter as necessary. B. Clean or replace filters. C. Allow air to move freely around unit
Uneven spray pattern	A. Air cap holes plugged. B. Dry solution on fluid tip.	A. Clean air cap B. Clean tip
Material leaking from cup and/or bubbling in cup.	A. Gasket leaking	A. Replace gasket. B. Check lid assembly for leaks.
Material leaking in gun body. Cup gun	A. Packing loose. B. Crack in nozzle holder or fluid fitting.	A. Packing needs adjustment. B. Replace nozzle holder or fluid fitting.
Not spraying or inconsistent material flow (Spitting). Cup gun	A. Air cap too close to nozzle B. Dry solution in fluid set. C. Material dried in cup pressure tube.	A. Increase the distance between the nozzle and air cap. B. Clean fluid set. C. Clean or replace hose.
Material leaking from fluid tip	A. Damage to needle or nozzle	A. Check and replace if needed.
Excessive over-spray	A. Excessive air volume for material being sprayed. B. Spraying too far from the surface.	A. Adjust speed switch to reduce air volume to gun. B. Spray 4" to 6" from surface.

## TURBINE PARTS

Turbine	P/N 51051-1
Switch 8 Amp.	P/N 41045
V-Speed	P/N 51076
Filter	P/N 95002 (2-pack)

## **Decibel Levels - Sprays of Rays II**

Noise level with a rheostat level of #4

At 3'            67.8 dB

At 10'           60.8 dB

Noise level with a rheostat level of #7

At 3'            77.0 dB

At 10'           68.8 dB

# WARRANTY

THIS NEW TURBINE UNIT IS COVERED UNDER WARRANTY AGAINST DEFECTS IN MATERIAL AND WORKMANSHIP FOR A PERIOD OF 4 YEARS FROM DATE OF PURCHASE.

THIS WARRANTY IS VALID WITH THE RETURN OF A SIGNED WARRANTY REGISTRATION CARD.

SPRAYS OF RAYS (A DIVISION OF AMERICAN TURBINE INC.) WILL AT ITS OPTION, REPAIR OR REPLACE ANY TURBINE UNIT FOUND TO BE DEFECTIVE DURING THE ABOVE STATED WARRANTY PERIOD.

NEGLECT, ABUSE, MISUSE OR MODIFICATION OF THE ORIGINAL EQUIPMENT WILL RENDER THIS WARRANTY NULL AND VOID.

## **WARNING AND CAUTIONS**

THIS SPRAYS OF RAYS SYSTEM IS DESIGNED FOR THE SPRAY TAN PROFESSIONAL. ALL COMPONENTS ARE UL APPROVED AND TESTED. BECAUSE OF THE SHORT TURBINE HOSE, THE DISTANCE FROM THE MATERIAL BEING SPRAYED TO THE TURBINE UNIT IS INTENDED FOR NON-VOLATILE SPRAYING ONLY.

THESE UNITS ARE PROVIDED WITH A THREE PRONGED GROUNDED POWER CORD. **DO NOT** REMOVE THE GROUNDING PRONG FOR ANY REASON. ANY EXTENSION CORDS USED MUST ALSO UTILIZE THE SAME CONFIGURATION.

**SPRAYS OF RAYS**  
A division of  
**AMERICAN TURBINE LLC**

2517 E. 7<sup>TH</sup> AVE.  
P.O.BOX 9115  
NORTH SAINT PAUL, MN 55109

Phone: 651-748-8030

Fax: 651-748-0028

Toll Free: 1-877-748-4857

e-mail

[ati@american-turbine.com](mailto:ati@american-turbine.com)

web site

[www.spraysofrays.com](http://www.spraysofrays.com)  
[www.american-turbine.com](http://www.american-turbine.com)